



Introducing The Mountainview, a Meritus Signature.

This 4 bedroom 2 1/2 bath is great for taking advantage of views. With the kitchen, family room, and master bedroom facing the rear, this is the perfect lake or mountain home. The large front and rear porch are perfect for relaxing in the evening or cooking out. The family room is open to the second floor and the rear wall is full of glass to maximize your views. This home features a large kitchen with center-island. With the addition of the optional bonus room over the master bedroom, you gain a catwalk that is open to the family room and foyer below. The 3rd bedroom also has it's own optional sitting area that is perfect for a playroom, study, or extra storage. All four bedrooms feature walkin closets. This home has 9' ceilings on the first floor and 8' ceilings on the second floor.

MOUNTAINVIEW SPECIFICATIONS

4 Bedrooms – 2 1/2 Baths	
1st Floor	1,659
2nd Floor	878
Optional Balcony & Bonus	367
Optional Sitting Room	207
Total Heated Sq Ft	3,111
Garage	
Garage	545
Front Porch	260
Rear Porch	158
Total Under Roof Sq Ft	4,074

Designed For Living. Built To Last.

More Information~
Call 1.888.701.1717

2508-A North Main Street
Anderson, South Carolina 29621

www.meritushomes.com

The Mountainview

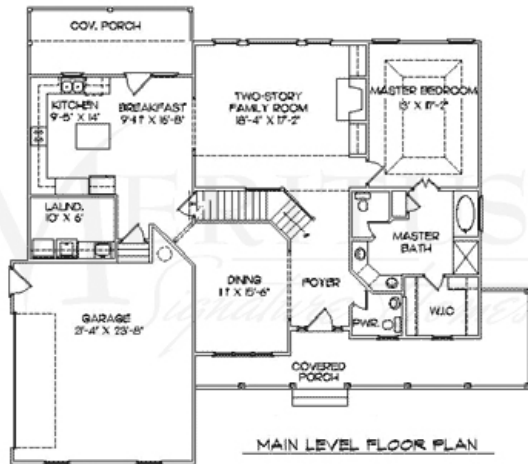

FIRST FLOOR

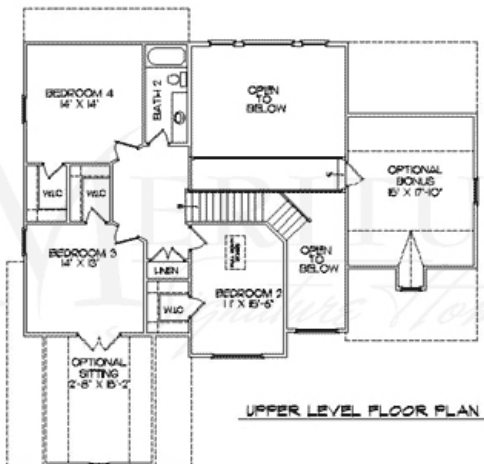

SECOND FLOOR

GENERAL FEATURES

- Elegant Wainscoting, Chair Rail, & Crown Molding in Dining Room
- Traditional Casing around Windows & Doors
- Hardwood Floors in Foyer
- Quality Carpeting by Shaw in a wide choice of Colors with 8 lb. Pad
- Vinyl Flooring in all Baths, Kitchen, & Laundry
- Cabinets with Lifetime Warranty
- Volume Ceilings throughout with Tray and Vaulted Ceilings per plan
- Low Maintenance Vinyl Windows with Grilles between the Low – E glass
- Plumbing Fixtures by Moen
- 30 Year Architectural Shingles
- Vinyl Siding
- Garage Doors with 2 Remotes
- 2 Exterior Hose Bibs & Front and Rear Flood Lights

KITCHEN

- Laminate Counter Tops
- Energy Efficient Appliances including a Smooth Top Range, Microwave / Hood Combo, Dishwasher, and Disposal
- Stainless Steel Sink with Moen Faucet and Vegetable Sprayer

BATHS

- Cultured Marble Bath Vanity Tops with Integrated Bowls
- Moen Faucets
- Matching Bath Accessories

CONVENIENCES

- 50 Gallon Electric Water Heater
- Electric Door Chime & Smoke Detectors
- Each Home is Professionally Cleaned prior to Move-in
- Individual Electric Heat Pump for Each Level of Home
- Pressure Treated Wood Decks Per Plan
- Concrete Floors Porches with Vinyl or Wrought Iron Hand Rails

OPTIONS & UPGRADES AVAILABLE

- Poured Wall Basements
- Brick, Cultured Stone, or Fiber-Cement Siding on Exterior
- Screen Porches, Sunrooms, & Bonus Rooms
- Gas Log Fireplaces
- Solid Surface Counter Tops
- Central Vacuum
- Tile Flooring
- Whirlpool Tubs and Tile Showers with Frameless Shower Doors
- Full Landscaping